

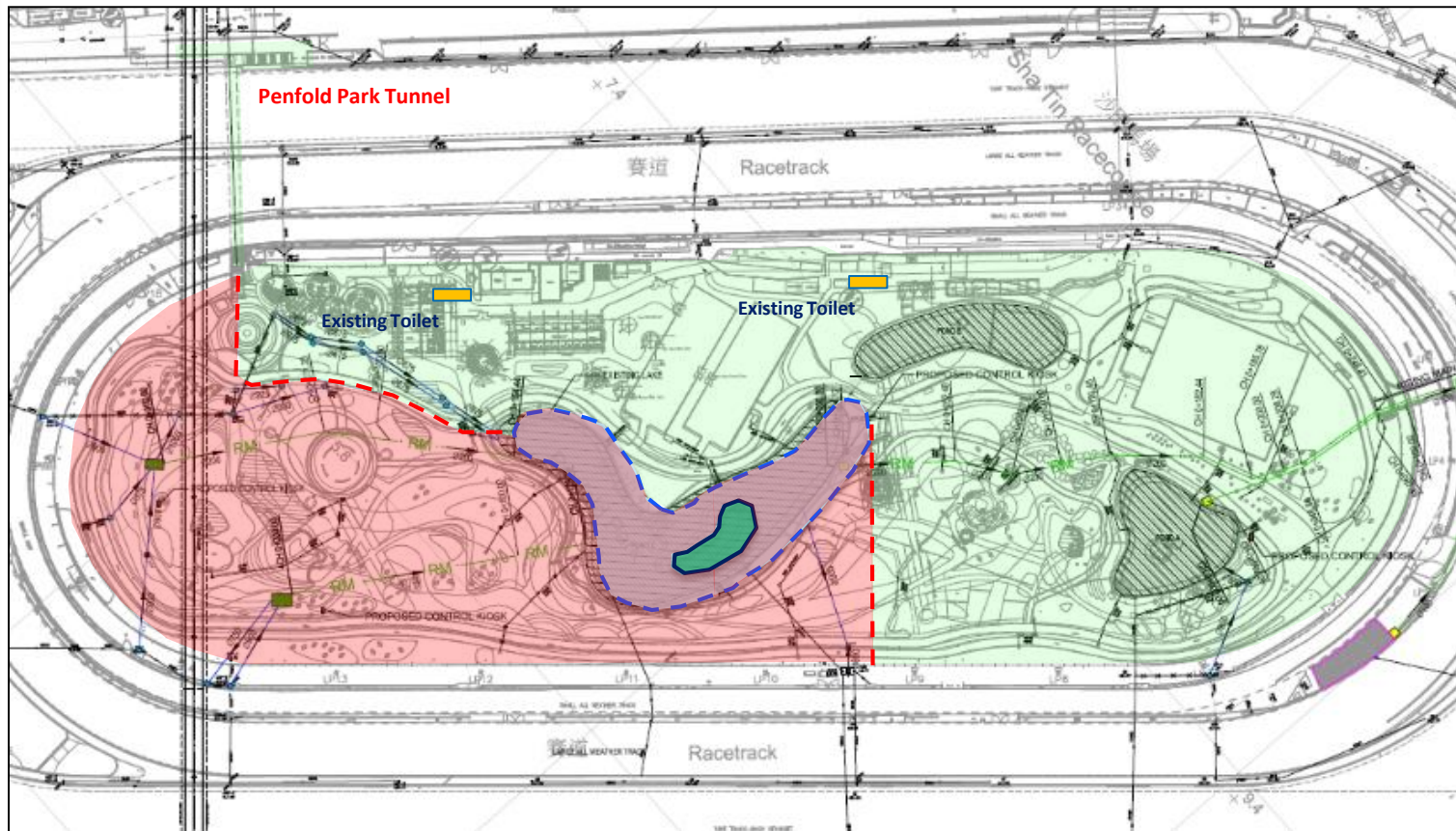

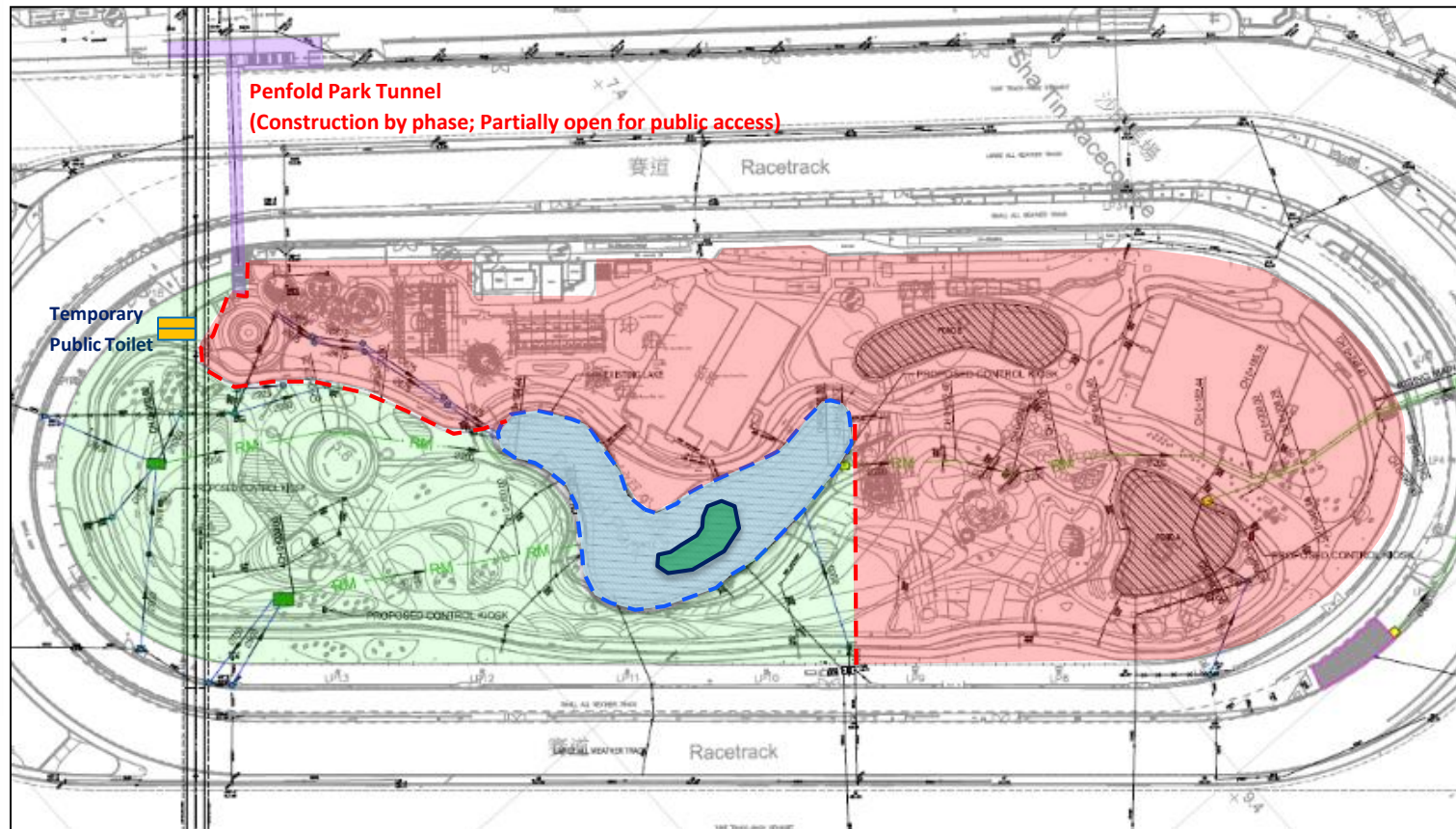

CONSTRUCTION PHASE 1 – FEB 2023 TO MAY 2024 (16 MONTHS)



-  Construction Area
(No access to public)
-  Open to Public
-  Tree Island
-  Hoarding with Corrugated Sheet
and Acoustic Canvas
-  Water Barrier

CONSTRUCTION PHASE 2 – JUN 2024 TO OCT 2025 (17 MONTHS)



-  Construction Area
(No access to public)
-  Open to Public
-  Construction by phase
(Partially open for public access)
-  Tree Island
-  Hoarding with Corrugated Sheet
and Acoustic Canvas
-  Water Barrier